



phone 231.773.5998
 toll-free 800.733.5998
 fax 231.773.6537

Trace Analytical Laboratories, Inc.
 2241 Black Creek Road
 Muskegon, MI 49444-2673
 info@trace-labs.com
 www.trace-labs.com

State of Michigan Laboratory ID: 8001

February 10, 2017

Mr. Stephen King
 Birmingham Public Schools
 2305 Cole Street
 Birmingham, MI 48009

Berkshire

PROJECT: Berkshire

TRACE ID: T16L163-16

Sample Point Description	Collected	Collected By	Received at Laboratory			
BK-16-CF	12/4/16 7:04	eb/nws/jjs	12/9/16 14:55			
Metals, Total	RESULT	* MCL	PREPARED	ANALYZED	BY	METHOD
Copper	0.81 mg/L	1.3	12/27/16 9:13	2/1/17 18:10	dtm	EPA 200.8 Rev. 5.4
Lead	0.010 mg/L	0.015	12/27/16 9:13	2/1/17 18:10	dtm	EPA 200.8 Rev. 5.4

TRACE ID: T16L163-17

Sample Point Description	Collected	Collected By	Received at Laboratory			
BK-17-CF	12/4/16 7:04	eb/nws/jjs	12/9/16 14:55			
Metals, Total	RESULT	* MCL	PREPARED	ANALYZED	BY	METHOD
Copper	0.59 mg/L	1.3	12/27/16 9:13	2/1/17 18:13	dtm	EPA 200.8 Rev. 5.4
Lead	0.013 mg/L	0.015	12/27/16 9:13	2/1/17 18:13	dtm	EPA 200.8 Rev. 5.4

TRACE ID: T16L163-18

Sample Point Description	Collected	Collected By	Received at Laboratory			
BK-18-CF	12/4/16 7:04	eb/nws/jjs	12/9/16 14:55			
Metals, Total	RESULT	* MCL	PREPARED	ANALYZED	BY	METHOD
Copper	0.55 mg/L	1.3	12/27/16 9:13	2/1/17 18:16	dtm	EPA 200.8 Rev. 5.4
Lead	0.0026 mg/L	0.015	12/27/16 9:13	2/1/17 18:16	dtm	EPA 200.8 Rev. 5.4

* The MCL (Maximum Contamination Limit) is the maximum concentration allowed under the Federal Safe Drinking Water Act. Results that are reported in bold or red have equaled or exceeded the MCL.

Jon Mink

Jon Mink
 Senior Project Manager



phone 231.773.5998
 toll-free 800.733.5998
 fax 231.773.6537

Trace Analytical Laboratories, Inc.
 2241 Black Creek Road
 Muskegon, MI 49444-2673
 info@trace-labs.com
 www.trace-labs.com

State of Michigan Laboratory ID: 8001

February 10, 2017

Mr. Stephen King
 Birmingham Public Schools
 2305 Cole Street
 Birmingham, MI 48009

PROJECT: Berkshire

TRACE ID: T16L163-19

Sample Point Description	Collected	Collected By	Received at Laboratory			
BK-19-CF	12/4/16 7:04	eb/nws/js	12/9/16 14:55			
Metals, Total	RESULT	* MCL	PREPARED	ANALYZED	BY	METHOD
Copper	0.54 mg/L	1.3	12/27/16 9:13	2/1/17 18:18	dtm	EPA 200.8 Rev. 5.4
Lead	0.0046 mg/L	0.015	12/27/16 9:13	2/1/17 18:18	dtm	EPA 200.8 Rev. 5.4

TRACE ID: T16L163-20

Sample Point Description	Collected	Collected By	Received at Laboratory			
BK-20-CF	12/4/16 7:04	eb/nws/js	12/9/16 14:55			
Metals, Total	RESULT	* MCL	PREPARED	ANALYZED	BY	METHOD
Copper	0.68 mg/L	1.3	12/27/16 9:13	2/1/17 18:21	dtm	EPA 200.8 Rev. 5.4
Lead	0.0028 mg/L	0.015	12/27/16 9:13	2/1/17 18:21	dtm	EPA 200.8 Rev. 5.4

TRACE ID: T16L163-21

Sample Point Description	Collected	Collected By	Received at Laboratory			
BK-21-CF	12/4/16 7:04	eb/nws/js	12/9/16 14:55			
Metals, Total	RESULT	* MCL	PREPARED	ANALYZED	BY	METHOD
Copper	1.6 mg/L	1.3	12/27/16 9:13	2/2/17 16:33	dtm	EPA 200.8 Rev. 5.4
Lead	0.015 mg/L	0.015	12/27/16 9:13	2/1/17 18:24	dtm	EPA 200.8 Rev. 5.4

* The MCL (Maximum Contamination Limit) is the maximum concentration allowed under the Federal Safe Drinking Water Act. Results that are reported in bold or red have equaled or exceeded the MCL.

Jon Mink
 Senior Project Manager



phone 231.773.5998
 toll-free 800.733.5998
 fax 231.773.6537

Trace Analytical Laboratories, Inc.
 2241 Black Creek Road
 Muskegon, MI 49444-2673
 info@trace-labs.com
 www.trace-labs.com

State of Michigan Laboratory ID: 8001

February 10, 2017

Mr. Stephen King
 Birmingham Public Schools
 2305 Cole Street
 Birmingham, MI 48009

PROJECT: Berkshire

TRACE ID: T16L163-22

Sample Point Description	Collected	Collected By	Received at Laboratory			
BK-22-CF	12/4/16 7:04	eb/nws/js	12/9/16 14:55			
Metals, Total	RESULT	* MCL	PREPARED	ANALYZED	BY	METHOD
Copper	0.64 mg/L	1.3	12/27/16 9:13	2/1/17 18:32	dtm	EPA 200.8 Rev. 5.4
Lead	0.0060 mg/L	0.015	12/27/16 9:13	2/1/17 18:32	dtm	EPA 200.8 Rev. 5.4

TRACE ID: T16L163-23

Sample Point Description	Collected	Collected By	Received at Laboratory			
BK-23-DF	12/4/16 7:05	eb/nws/js	12/9/16 14:55			
Metals, Total	RESULT	* MCL	PREPARED	ANALYZED	BY	METHOD
Copper	0.074 mg/L	1.3	12/27/16 9:17	2/1/17 18:40	dtm	EPA 200.8 Rev. 5.4
Lead	0.0013 mg/L	0.015	12/27/16 9:17	2/1/17 18:40	dtm	EPA 200.8 Rev. 5.4

TRACE ID: T16L163-24

Sample Point Description	Collected	Collected By	Received at Laboratory			
BK-24-CF	12/4/16 7:05	eb/nws/js	12/9/16 14:55			
Metals, Total	RESULT	* MCL	PREPARED	ANALYZED	BY	METHOD
Copper	0.39 mg/L	1.3	12/27/16 9:17	2/1/17 18:45	dtm	EPA 200.8 Rev. 5.4
Lead	0.0021 mg/L	0.015	12/27/16 9:17	2/1/17 18:45	dtm	EPA 200.8 Rev. 5.4

* The MCL (Maximum Contamination Limit) is the maximum concentration allowed under the Federal Safe Drinking Water Act. Results that are reported in bold or red have equaled or exceeded the MCL.

Jon Mink
 Senior Project Manager



phone 231.773.5998
 toll-free 800.733.5998
 fax 231.773.6537

Trace Analytical Laboratories, Inc.
 2241 Black Creek Road
 Muskegon, MI 49444-2673
 info@trace-labs.com
 www.trace-labs.com

State of Michigan Laboratory ID: 8001

February 10, 2017

Mr. Stephen King
 Birmingham Public Schools
 2305 Cole Street
 Birmingham, MI 48009

PROJECT: Berkshire

TRACE ID: T16L163-25

Sample Point Description	Collected	Collected By	Received at Laboratory			
BK-25-CF	12/4/16 7:05	eb/nws/js	12/9/16 14:55			
Metals, Total	RESULT	* MCL	PREPARED	ANALYZED	BY	METHOD
Copper	0.63 mg/L	1.3	12/27/16 9:17	2/1/17 18:48	dtm	EPA 200.8 Rev. 5.4
Lead	0.049 mg/L	0.015	12/27/16 9:17	2/1/17 18:48	dtm	EPA 200.8 Rev. 5.4

TRACE ID: T16L163-26

Sample Point Description	Collected	Collected By	Received at Laboratory			
BK-26-CF	12/4/16 7:13	eb/nws/js	12/9/16 14:55			
Metals, Total	RESULT	* MCL	PREPARED	ANALYZED	BY	METHOD
Copper	1.9 mg/L	1.3	12/27/16 9:17	2/2/17 16:44	dtm	EPA 200.8 Rev. 5.4
Lead	0.017 mg/L	0.015	12/27/16 9:17	2/1/17 18:50	dtm	EPA 200.8 Rev. 5.4

TRACE ID: T16L163-27

Sample Point Description	Collected	Collected By	Received at Laboratory			
BK-27-CF	12/4/16 7:13	eb/nws/js	12/9/16 14:55			
Metals, Total	RESULT	* MCL	PREPARED	ANALYZED	BY	METHOD
Copper	1.6 mg/L	1.3	12/27/16 9:17	2/2/17 16:47	dtm	EPA 200.8 Rev. 5.4
Lead	0.016 mg/L	0.015	12/27/16 9:17	2/1/17 18:53	dtm	EPA 200.8 Rev. 5.4

* The MCL (Maximum Contamination Limit) is the maximum concentration allowed under the Federal Safe Drinking Water Act. Results that are reported in bold or red have equaled or exceeded the MCL.

Jon Mink
 Senior Project Manager



phone 231.773.5998
 toll-free 800.733.5998
 fax 231.773.6537

Trace Analytical Laboratories, Inc.
 2241 Black Creek Road
 Muskegon, MI 49444-2673
 info@trace-labs.com
 www.trace-labs.com

State of Michigan Laboratory ID: 8001

February 10, 2017

Mr. Stephen King
 Birmingham Public Schools
 2305 Cole Street
 Birmingham, MI 48009

PROJECT: Berkshire

TRACE ID: T16L163-28

Sample Point Description	Collected	Collected By	Received at Laboratory			
BK-28-CF	12/4/16 7:13	eb/nws/js	12/9/16 14:55			
Metals, Total	RESULT	* MCL	PREPARED	ANALYZED	BY	METHOD
Copper	1.8 mg/L	1.3	12/27/16 9:17	2/2/17 16:49	dtm	EPA 200.8 Rev. 5.4
Lead	0.052 mg/L	0.015	12/27/16 9:17	2/1/17 18:56	dtm	EPA 200.8 Rev. 5.4

TRACE ID: T16L163-29

Sample Point Description	Collected	Collected By	Received at Laboratory			
BK-29-CF	12/4/16 7:13	eb/nws/js	12/9/16 14:55			
Metals, Total	RESULT	* MCL	PREPARED	ANALYZED	BY	METHOD
Copper	1.4 mg/L	1.3	12/27/16 9:17	2/2/17 16:52	dtm	EPA 200.8 Rev. 5.4
Lead	0.022 mg/L	0.015	12/27/16 9:17	2/1/17 19:07	dtm	EPA 200.8 Rev. 5.4

TRACE ID: T16L163-30

Sample Point Description	Collected	Collected By	Received at Laboratory			
BK-30-CF	12/4/16 7:13	eb/nws/js	12/9/16 14:55			
Metals, Total	RESULT	* MCL	PREPARED	ANALYZED	BY	METHOD
Copper	1.6 mg/L	1.3	12/27/16 9:17	2/2/17 16:55	dtm	EPA 200.8 Rev. 5.4
Lead	0.025 mg/L	0.015	12/27/16 9:17	2/1/17 19:09	dtm	EPA 200.8 Rev. 5.4

* The MCL (Maximum Contamination Limit) is the maximum concentration allowed under the Federal Safe Drinking Water Act. Results that are reported in bold or red have equaled or exceeded the MCL.

Jon Mink
 Senior Project Manager



phone 231.773.5998
 toll-free 800.733.5998
 fax 231.773.6537

Trace Analytical Laboratories, Inc.
 2241 Black Creek Road
 Muskegon, MI 49444-2673
 info@trace-labs.com
 www.trace-labs.com

State of Michigan Laboratory ID: 8001

February 10, 2017

Mr. Stephen King
 Birmingham Public Schools
 2305 Cole Street
 Birmingham, MI 48009

PROJECT: Berkshire

TRACE ID: T16L163-31

Sample Point Description	Collected	Collected By	Received at Laboratory			
BK-31-CF	12/4/16 7:13	eb/nws/js	12/9/16 14:55			
Metals, Total	RESULT	* MCL	PREPARED	ANALYZED	BY	METHOD
Copper	1.4 mg/L	1.3	12/27/16 9:17	2/2/17 16:57	dtm	EPA 200.8 Rev. 5.4
Lead	0.016 mg/L	0.015	12/27/16 9:17	2/1/17 19:12	dtm	EPA 200.8 Rev. 5.4

TRACE ID: T16L163-32

Sample Point Description	Collected	Collected By	Received at Laboratory			
BK-32-CF	12/4/16 7:13	eb/nws/js	12/9/16 14:55			
Metals, Total	RESULT	* MCL	PREPARED	ANALYZED	BY	METHOD
Copper	0.81 mg/L	1.3	12/27/16 9:17	2/1/17 19:15	dtm	EPA 200.8 Rev. 5.4
Lead	0.0051 mg/L	0.015	12/27/16 9:17	2/1/17 19:15	dtm	EPA 200.8 Rev. 5.4

TRACE ID: T16L163-33

Sample Point Description	Collected	Collected By	Received at Laboratory			
BK-33-CF	12/4/16 7:13	eb/nws/js	12/9/16 14:55			
Metals, Total	RESULT	* MCL	PREPARED	ANALYZED	BY	METHOD
Copper	3.6 mg/L	1.3	12/27/16 9:17	2/2/17 17:00	dtm	EPA 200.8 Rev. 5.4
Lead	0.018 mg/L	0.015	12/27/16 9:17	2/1/17 19:17	dtm	EPA 200.8 Rev. 5.4

* The MCL (Maximum Contamination Limit) is the maximum concentration allowed under the Federal Safe Drinking Water Act. Results that are reported in bold or red have equaled or exceeded the MCL.

Jon Mink
 Senior Project Manager



phone 231.773.5998
 toll-free 800.733.5998
 fax 231.773.6537

Trace Analytical Laboratories, Inc.
 2241 Black Creek Road
 Muskegon, MI 49444-2673
 info@trace-labs.com
 www.trace-labs.com

State of Michigan Laboratory ID: 8001

February 10, 2017

Mr. Stephen King
 Birmingham Public Schools
 2305 Cole Street
 Birmingham, MI 48009

PROJECT: Berkshire

TRACE ID: T16L163-34

Sample Point Description	Collected	Collected By	Received at Laboratory			
BK-34-CF	12/14/16 7:13	eb/nws/js	12/9/16 14:55			
Metals, Total	RESULT	* MCL	PREPARED	ANALYZED	BY	METHOD
Copper	2.3 mg/L	1.3	12/27/16 9:17	2/2/17 17:03	dtm	EPA 200.8 Rev. 5.4
Lead	0.018 mg/L	0.015	12/27/16 9:17	2/1/17 19:20	dtm	EPA 200.8 Rev. 5.4

TRACE ID: T16L163-35

Sample Point Description	Collected	Collected By	Received at Laboratory			
BK-35-CF	12/14/16 7:13	eb/nws/js	12/9/16 14:55			
Metals, Total	RESULT	* MCL	PREPARED	ANALYZED	BY	METHOD
Copper	0.83 mg/L	1.3	12/27/16 9:17	2/1/17 19:23	dtm	EPA 200.8 Rev. 5.4
Lead	0.012 mg/L	0.015	12/27/16 9:17	2/1/17 19:23	dtm	EPA 200.8 Rev. 5.4

TRACE ID: T16L163-36

Sample Point Description	Collected	Collected By	Received at Laboratory			
BK-36-CF	12/14/16 7:13	eb/nws/js	12/9/16 14:55			
Metals, Total	RESULT	* MCL	PREPARED	ANALYZED	BY	METHOD
Copper	3.7 mg/L	1.3	12/27/16 9:17	2/2/17 17:05	dtm	EPA 200.8 Rev. 5.4
Lead	0.039 mg/L	0.015	12/27/16 9:17	2/1/17 19:25	dtm	EPA 200.8 Rev. 5.4

* The MCL (Maximum Contamination Limit) is the maximum concentration allowed under the Federal Safe Drinking Water Act. Results that are reported in bold or red have equaled or exceeded the MCL.

Jon Mink
 Senior Project Manager



phone 231.773.5998
 toll-free 800.733.5998
 fax 231.773.6537

Trace Analytical Laboratories, Inc.
 2241 Black Creek Road
 Muskegon, MI 49444-2673
 info@trace-labs.com
 www.trace-labs.com

State of Michigan Laboratory ID: 8001

February 10, 2017

Mr. Stephen King
 Birmingham Public Schools
 2305 Cole Street
 Birmingham, MI 48009

PROJECT: Berkshire

TRACE ID: T16L163-37

Sample Point Description BK-37-CF *Collected* 12/4/16 7:13 *Collected By* eb/nws/js *Received at Laboratory* 12/9/16 14:55

Metals, Total	RESULT	* MCL	PREPARED	ANALYZED	BY	METHOD
Copper	1.7 mg/L	1.3	12/27/16 9:17	2/2/17 17:08	dtm	EPA 200.8 Rev. 5.4
Lead	0.016 mg/L	0.015	12/27/16 9:17	2/1/17 19:28	dtm	EPA 200.8 Rev. 5.4

TRACE ID: T16L163-38

Sample Point Description BK-38-DF *Collected* 12/4/16 7:15 *Collected By* eb/nws/js *Received at Laboratory* 12/9/16 14:55

Metals, Total	RESULT	* MCL	PREPARED	ANALYZED	BY	METHOD
Copper	0.11 mg/L	1.3	12/27/16 9:17	2/1/17 19:31	dtm	EPA 200.8 Rev. 5.4
Lead	<0.0010 mg/L	0.015	12/27/16 9:17	2/1/17 19:31	dtm	EPA 200.8 Rev. 5.4

TRACE ID: T16L163-39

Sample Point Description BK-39-BF *Collected* 12/4/16 7:15 *Collected By* eb/nws/js *Received at Laboratory* 12/9/16 14:55

Metals, Total	RESULT	* MCL	PREPARED	ANALYZED	BY	METHOD
Copper	0.14 mg/L	1.3	12/27/16 9:17	2/1/17 19:39	dtm	EPA 200.8 Rev. 5.4
Lead	0.0033 mg/L	0.015	12/27/16 9:17	2/1/17 19:39	dtm	EPA 200.8 Rev. 5.4

* The MCL (Maximum Contamination Limit) is the maximum concentration allowed under the Federal Safe Drinking Water Act. Results that are reported in bold or red have equaled or exceeded the MCL.

Jon Mink
 Senior Project Manager



phone 231.773.5998
 toll-free 800.733.5998
 fax 231.773.6537

Trace Analytical Laboratories, Inc.
 2241 Black Creek Road
 Muskegon, MI 49444-2673
 info@trace-labs.com
 www.trace-labs.com

State of Michigan Laboratory ID: 8001

February 10, 2017

Mr. Stephen King
 Birmingham Public Schools
 2305 Cole Street
 Birmingham, MI 48009

PROJECT: Berkshire

TRACE ID: T16L163-46

Sample Point Description	Collected	Collected By	Received at Laboratory			
BK-46-CF	12/4/16 7:21	eb/nws/js	12/9/16 14:55			
Metals, Total	RESULT	* MCL	PREPARED	ANALYZED	BY	METHOD
Copper	0.76 mg/L	1.3	12/27/16 9:20	2/1/17 20:14	dtm	EPA 200.8 Rev. 5.4
Lead	0.0030 mg/L	0.015	12/27/16 9:20	2/1/17 20:14	dtm	EPA 200.8 Rev. 5.4

TRACE ID: T16L163-47

Sample Point Description	Collected	Collected By	Received at Laboratory			
BK-47-CF	12/4/16 7:21	eb/nws/js	12/9/16 14:55			
Metals, Total	RESULT	* MCL	PREPARED	ANALYZED	BY	METHOD
Copper	0.82 mg/L	1.3	12/27/16 9:20	2/1/17 20:16	dtm	EPA 200.8 Rev. 5.4
Lead	0.0012 mg/L	0.015	12/27/16 9:20	2/1/17 20:16	dtm	EPA 200.8 Rev. 5.4

TRACE ID: T16L163-48

Sample Point Description	Collected	Collected By	Received at Laboratory			
BK-48-CF	12/4/16 7:21	eb/nws/js	12/9/16 14:55			
Metals, Total	RESULT	* MCL	PREPARED	ANALYZED	BY	METHOD
Copper	0.83 mg/L	1.3	12/27/16 9:20	2/1/17 20:19	dtm	EPA 200.8 Rev. 5.4
Lead	0.0035 mg/L	0.015	12/27/16 9:20	2/1/17 20:19	dtm	EPA 200.8 Rev. 5.4

* The MCL (Maximum Contamination Limit) is the maximum concentration allowed under the Federal Safe Drinking Water Act. Results that are reported in bold or red have equaled or exceeded the MCL.

Jon Mink
 Senior Project Manager



phone 231.773.5998
 toll-free 800.733.5998
 fax 231.773.6537

Trace Analytical Laboratories, Inc.
 2241 Black Creek Road
 Muskegon, MI 49444-2673
 info@trace-labs.com
 www.trace-labs.com

State of Michigan Laboratory ID: 8001

February 10, 2017

Mr. Stephen King
 Birmingham Public Schools
 2305 Cole Street
 Birmingham, MI 48009

PROJECT: Berkshire

TRACE ID: T16L163-49

Sample Point Description BK-49-CF *Collected* 12/4/16 7:21 *Collected By* eb/nws/js *Received at Laboratory* 12/9/16 14:55

Metals, Total	RESULT	* MCL	PREPARED	ANALYZED	BY	METHOD
Copper	0.88 mg/L	1.3	12/27/16 9:20	2/1/17 20:22	dtm	EPA 200.8 Rev. 5.4
Lead	0.0013 mg/L	0.015	12/27/16 9:20	2/1/17 20:22	dtm	EPA 200.8 Rev. 5.4

TRACE ID: T16L163-50

Sample Point Description BK-50-CF *Collected* 12/4/16 7:21 *Collected By* eb/nws/js *Received at Laboratory* 12/9/16 14:55

Metals, Total	RESULT	* MCL	PREPARED	ANALYZED	BY	METHOD
Copper	0.50 mg/L	1.3	12/27/16 9:20	2/1/17 20:24	dtm	EPA 200.8 Rev. 5.4
Lead	<0.0010 mg/L	0.015	12/27/16 9:20	2/1/17 20:24	dtm	EPA 200.8 Rev. 5.4

TRACE ID: T16L163-51

Sample Point Description BK-51-CF *Collected* 12/4/16 7:21 *Collected By* eb/nws/js *Received at Laboratory* 12/9/16 14:55

Metals, Total	RESULT	* MCL	PREPARED	ANALYZED	BY	METHOD
Copper	3.1 mg/L	1.3	12/27/16 9:20	2/2/17 17:22	dtm	EPA 200.8 Rev. 5.4
Lead	0.18 mg/L	0.015	12/27/16 9:20	2/2/17 17:22	dtm	EPA 200.8 Rev. 5.4

* The MCL (Maximum Contamination Limit) is the maximum concentration allowed under the Federal Safe Drinking Water Act. Results that are reported in bold or red have equaled or exceeded the MCL.

Jon Mink
 Senior Project Manager



phone 231.773.5998
 toll-free 800.733.5998
 fax 231.773.6537

Trace Analytical Laboratories, Inc.
 2241 Black Creek Road
 Muskegon, MI 49444-2673
 info@trace-labs.com
 www.trace-labs.com

State of Michigan Laboratory ID: 8001

February 10, 2017

Mr. Stephen King
 Birmingham Public Schools
 2305 Cole Street
 Birmingham, MI 48009

PROJECT: Berkshire

TRACE ID: T16L163-52

Sample Point Description	Collected	Collected By	Received at Laboratory			
BK-52-CF	12/4/16 7:21	eb/nws/jjs	12/9/16 14:55			
Metals, Total	RESULT	* MCL	PREPARED	ANALYZED	BY	METHOD
Copper	0.70 mg/L	1.3	12/27/16 9:20	2/1/17 20:30	dtm	EPA 200.8 Rev. 5.4
Lead	0.0019 mg/L	0.015	12/27/16 9:20	2/1/17 20:30	dtm	EPA 200.8 Rev. 5.4

TRACE ID: T16L163-53

Sample Point Description	Collected	Collected By	Received at Laboratory			
BK-53-CF	12/4/16 7:22	eb/nws/jjs	12/9/16 14:55			
Metals, Total	RESULT	* MCL	PREPARED	ANALYZED	BY	METHOD
Copper	0.52 mg/L	1.3	12/27/16 9:20	2/1/17 20:33	dtm	EPA 200.8 Rev. 5.4
Lead	0.018 mg/L	0.015	12/27/16 9:20	2/1/17 20:33	dtm	EPA 200.8 Rev. 5.4

TRACE ID: T16L163-54

Sample Point Description	Collected	Collected By	Received at Laboratory			
BK-54-CF	12/4/16 7:26	eb/nws/jjs	12/9/16 14:55			
Metals, Total	RESULT	* MCL	PREPARED	ANALYZED	BY	METHOD
Copper	0.43 mg/L	1.3	12/27/16 9:20	2/1/17 20:35	dtm	EPA 200.8 Rev. 5.4
Lead	<0.0010 mg/L	0.015	12/27/16 9:20	2/1/17 20:35	dtm	EPA 200.8 Rev. 5.4

* The MCL (Maximum Contamination Limit) is the maximum concentration allowed under the Federal Safe Drinking Water Act. Results that are reported in bold or red have equaled or exceeded the MCL.

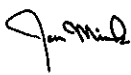
 Jon Mink
 Senior Project Manager



phone 231.773.5998
toll-free 800.733.5998
fax 231.773.6537

Trace Analytical Laboratories, Inc.
 2241 Black Creek Road
 Muskegon, MI 49444-2673
 info@trace-labs.com
 www.trace-labs.com

State of Michigan Laboratory ID: 8001

February 10, 2017

Mr. Stephen King
 Birmingham Public Schools
 2305 Cole Street
 Birmingham, MI 48009

PROJECT: Berkshire

TRACE ID: T16L163-55

Sample Point Description
 BK-55-CF

Collected
 12/4/16 7:26

Collected By
 eb/nws/js

Received at Laboratory
 12/9/16 14:55

Metals, Total	RESULT	* MCL	PREPARED	ANALYZED	BY	METHOD
Copper	0.31 mg/L	1.3	12/27/16 9:20	2/1/17 20:38	dtm	EPA 200.8 Rev. 5.4
Lead	<0.0010 mg/L	0.015	12/27/16 9:20	2/1/17 20:38	dtm	EPA 200.8 Rev. 5.4

TRACE ID: T16L163-56

Sample Point Description
 BK-56-CF

Collected
 12/4/16 7:26

Collected By
 eb/nws/js

Received at Laboratory
 12/9/16 14:55

Metals, Total	RESULT	* MCL	PREPARED	ANALYZED	BY	METHOD
Copper	0.79 mg/L	1.3	12/27/16 9:20	2/1/17 20:49	dtm	EPA 200.8 Rev. 5.4
Lead	0.0025 mg/L	0.015	12/27/16 9:20	2/1/17 20:49	dtm	EPA 200.8 Rev. 5.4

TRACE ID: T16L163-57

Sample Point Description
 BK-57-CF

Collected
 12/4/16 7:26

Collected By
 eb/nws/js

Received at Laboratory
 12/9/16 14:55

Metals, Total	RESULT	* MCL	PREPARED	ANALYZED	BY	METHOD
Copper	0.77 mg/L	1.3	12/27/16 9:20	2/1/17 20:52	dtm	EPA 200.8 Rev. 5.4
Lead	0.0016 mg/L	0.015	12/27/16 9:20	2/1/17 20:52	dtm	EPA 200.8 Rev. 5.4

* The MCL (Maximum Contamination Limit) is the maximum concentration allowed under the Federal Safe Drinking Water Act. Results that are reported in bold or red have equaled or exceeded the MCL.

Jon Mink
 Senior Project Manager



phone 231.773.5998 Trace Analytical Laboratories, Inc.
 toll-free 800.733.5998 2241 Black Creek Road
 fax 231.773.6537 Muskegon, MI 49444-2673
 info@trace-labs.com
 www.trace-labs.com

State of Michigan Laboratory ID: 8001

February 10, 2017

Mr. Stephen King
 Birmingham Public Schools
 2305 Cole Street
 Birmingham, MI 48009

PROJECT: Berkshire

TRACE ID: T16L163-58

Sample Point Description	Collected	Collected By	Received at Laboratory			
BK-58-CF	12/4/16 7:26	eb/nws/jjs	12/9/16 14:55			
Metals, Total	RESULT	* MCL	PREPARED	ANALYZED	BY	METHOD
Copper	0.86 mg/L	1.3	12/27/16 9:20	2/1/17 20:54	dtm	EPA 200.8 Rev. 5.4
Lead	<0.0010 mg/L	0.015	12/27/16 9:20	2/1/17 20:54	dtm	EPA 200.8 Rev. 5.4

TRACE ID: T16L163-59

Sample Point Description	Collected	Collected By	Received at Laboratory			
BK-59-CF	12/4/16 7:26	eb/nws/jjs	12/9/16 14:55			
Metals, Total	RESULT	* MCL	PREPARED	ANALYZED	BY	METHOD
Copper	0.79 mg/L	1.3	12/27/16 9:20	2/1/17 20:57	dtm	EPA 200.8 Rev. 5.4
Lead	0.0012 mg/L	0.015	12/27/16 9:20	2/1/17 20:57	dtm	EPA 200.8 Rev. 5.4

TRACE ID: T16L163-60

Sample Point Description	Collected	Collected By	Received at Laboratory			
BK-60-CF	12/4/16 7:26	eb/nws/jjs	12/9/16 14:55			
Metals, Total	RESULT	* MCL	PREPARED	ANALYZED	BY	METHOD
Copper	0.56 mg/L	1.3	12/27/16 9:20	2/1/17 21:00	dtm	EPA 200.8 Rev. 5.4
Lead	0.0016 mg/L	0.015	12/27/16 9:20	2/1/17 21:00	dtm	EPA 200.8 Rev. 5.4

* The MCL (Maximum Contamination Limit) is the maximum concentration allowed under the Federal Safe Drinking Water Act. Results that are reported in bold or red have equaled or exceeded the MCL.

Jon Mink
 Senior Project Manager



phone 231.773.5998
 toll-free 800.733.5998
 fax 231.773.6537

Trace Analytical Laboratories, Inc.
 2241 Black Creek Road
 Muskegon, MI 49444-2673
 info@trace-labs.com
 www.trace-labs.com

State of Michigan Laboratory ID: 8001

February 10, 2017

Mr. Stephen King
 Birmingham Public Schools
 2305 Cole Street
 Birmingham, MI 48009

PROJECT: Berkshlre

TRACE ID: T16L163-61

Sample Point Description	Collected	Collected By	Received at Laboratory			
BK-61-CF	12/4/16 7:26	eb/nws/js	12/9/16 14:55			
Metals, Total	RESULT	* MCL	PREPARED	ANALYZED	BY	METHOD
Copper	0.78 mg/L	1.3	12/27/16 9:20	2/1/17 21:02	dtm	EPA 200.8 Rev. 5.4
Lead	0.0048 mg/L	0.015	12/27/16 9:20	2/1/17 21:02	dtm	EPA 200.8 Rev. 5.4

TRACE ID: T16L163-62

Sample Point Description	Collected	Collected By	Received at Laboratory			
BK-62-CF	12/4/16 7:26	eb/nws/js	12/9/16 14:55			
Metals, Total	RESULT	* MCL	PREPARED	ANALYZED	BY	METHOD
Copper	1.9 mg/L	1.3	2/6/17 16:24	2/8/17 14:18	dtm	EPA 200.8 Rev. 5.4
Lead	0.060 mg/L	0.015	2/6/17 16:24	2/7/17 14:36	dtm	EPA 200.8 Rev. 5.4

TRACE ID: T16L163-63

Sample Point Description	Collected	Collected By	Received at Laboratory			
BK-63-CF	12/4/16 7:27	eb/nws/js	12/9/16 14:55			
Metals, Total	RESULT	* MCL	PREPARED	ANALYZED	BY	METHOD
Copper	0.57 mg/L	1.3	12/27/16 9:22	2/1/17 21:10	dtm	EPA 200.8 Rev. 5.4
Lead	0.0025 mg/L	0.015	12/27/16 9:22	2/1/17 21:10	dtm	EPA 200.8 Rev. 5.4

* The MCL (Maximum Contamination Limit) is the maximum concentration allowed under the Federal Safe Drinking Water Act. Results that are reported in bold or red have equaled or exceeded the MCL.

Jon Mink
 Senior Project Manager



phone 231.773.5998 Trace Analytical Laboratories, Inc.
 toll-free 800.733.5998 2241 Black Creek Road
 fax 231.773.6537 Muskegon, MI 49444-2673
 info@trace-labs.com
 www.trace-labs.com

State of Michigan Laboratory ID: 8001

February 10, 2017

Mr. Stephen King
 Birmingham Public Schools
 2305 Cole Street
 Birmingham, MI 48009

PROJECT: Berkshire

TRACE ID: T16L163-AD

Sample Point Description	Collected	Collected By	Received at Laboratory			
BK-103-CF	12/4/16 8:16	eb/nws/jjs	12/9/16 14:55			
Metals, Total	RESULT	* MCL	PREPARED	ANALYZED	BY	METHOD
Copper	1.3 mg/L	1.3	12/27/16 9:24	2/2/17 17:27	dtm	EPA 200.8 Rev. 5.4
Lead	0.0040 mg/L	0.015	12/27/16 9:24	2/1/17 23:34	dtm	EPA 200.8 Rev. 5.4

TRACE ID: T16L163-AE

Sample Point Description	Collected	Collected By	Received at Laboratory			
BK-104-CF	12/4/16 8:19	eb/nws/jjs	12/9/16 14:55			
Metals, Total	RESULT	* MCL	PREPARED	ANALYZED	BY	METHOD
Copper	0.92 mg/L	1.3	12/27/16 9:24	2/2/17 17:30	dtm	EPA 200.8 Rev. 5.4
Lead	0.0099 mg/L	0.015	12/27/16 9:24	2/1/17 23:42	dtm	EPA 200.8 Rev. 5.4

TRACE ID: T16L163-AF

Sample Point Description	Collected	Collected By	Received at Laboratory			
BK-105-CF	12/4/16 8:18	eb/nws/jjs	12/9/16 14:55			
Metals, Total	RESULT	* MCL	PREPARED	ANALYZED	BY	METHOD
Copper	0.28 mg/L	1.3	12/27/16 9:24	2/1/17 23:45	dtm	EPA 200.8 Rev. 5.4
Lead	0.0097 mg/L	0.015	12/27/16 9:24	2/1/17 23:45	dtm	EPA 200.8 Rev. 5.4

* The MCL (Maximum Contamination Limit) is the maximum concentration allowed under the Federal Safe Drinking Water Act. Results that are reported in bold or red have equaled or exceeded the MCL.

Jon Mink
 Senior Project Manager



phone 231.773.5998
 toll-free 800.733.5998
 fax 231.773.6537

Trace Analytical Laboratories, Inc.
 2241 Black Creek Road
 Muskegon, MI 49444-2673
 info@trace-labs.com
 www.trace-labs.com

State of Michigan Laboratory ID: 8001

February 10, 2017

Mr. Stephen King
 Birmingham Public Schools
 2305 Cole Street
 Birmingham, MI 48009

PROJECT: Berkshire

TRACE ID: T16L163-AG

Sample Point Description	Collected	Collected By	Received at Laboratory			
BK-106-CF	12/4/16 8:17	eb/nws/js	12/9/16 14:55			
Metals, Total	RESULT	* MCL	PREPARED	ANALYZED	BY	METHOD
Copper	0.35 mg/L	1.3	12/27/16 9:26	2/1/17 23:53	dtm	EPA 200.8 Rev. 5.4
Lead	0.0012 mg/L	0.015	12/27/16 9:26	2/1/17 23:53	dtm	EPA 200.8 Rev. 5.4

TRACE ID: T16L163-AH

Sample Point Description	Collected	Collected By	Received at Laboratory			
BK-107-CF	12/4/16 8:36	eb/nws/js	12/9/16 14:55			
Metals, Total	RESULT	* MCL	PREPARED	ANALYZED	BY	METHOD
Copper	2.6 mg/L	1.3	12/27/16 9:26	2/2/17 17:35	dtm	EPA 200.8 Rev. 5.4
Lead	0.031 mg/L	0.015	12/27/16 9:26	2/1/17 23:59	dtm	EPA 200.8 Rev. 5.4

TRACE ID: T16L163-AI

Sample Point Description	Collected	Collected By	Received at Laboratory			
BK-108-CF	12/4/16 8:23	eb/nws/js	12/9/16 14:55			
Metals, Total	RESULT	* MCL	PREPARED	ANALYZED	BY	METHOD
Copper	0.55 mg/L	1.3	12/27/16 9:26	2/2/17 0:01	dtm	EPA 200.8 Rev. 5.4
Lead	0.0026 mg/L	0.015	12/27/16 9:26	2/2/17 0:01	dtm	EPA 200.8 Rev. 5.4

* The MCL (Maximum Contamination Limit) is the maximum concentration allowed under the Federal Safe Drinking Water Act. Results that are reported in bold or red have equaled or exceeded the MCL.

Jon Mink
 Senior Project Manager



phone 231.773.5998
 toll-free 800.733.5998
 fax 231.773.6537

Trace Analytical Laboratories, Inc.
 2241 Black Creek Road
 Muskegon, MI 49444-2673
 info@trace-labs.com
 www.trace-labs.com

State of Michigan Laboratory ID: 8001

February 10, 2017

Mr. Stephen King
 Birmingham Public Schools
 2305 Cole Street
 Birmingham, MI 48009

PROJECT: Berkshire

TRACE ID: T16L163-AJ

Sample Point Description	Collected	Collected By	Received at Laboratory			
BK-109-CF	12/4/16 8:20	eb/nws/jjs	12/9/16 14:55			
Metals, Total	RESULT	* MCL	PREPARED	ANALYZED	BY	METHOD
Copper	0.38 mg/L	1.3	12/27/16 9:26	2/2/17 0:04	dtm	EPA 200.8 Rev. 5.4
Lead	0.0030 mg/L	0.015	12/27/16 9:26	2/2/17 0:04	dtm	EPA 200.8 Rev. 5.4

TRACE ID: T16L163-AK

Sample Point Description	Collected	Collected By	Received at Laboratory			
BK-110-CF	12/4/16 8:22	eb/nws/jjs	12/9/16 14:55			
Metals, Total	RESULT	* MCL	PREPARED	ANALYZED	BY	METHOD
Copper	1.2 mg/L	1.3	12/27/16 9:26	2/2/17 17:38	dtm	EPA 200.8 Rev. 5.4
Lead	0.013 mg/L	0.015	12/27/16 9:26	2/2/17 0:07	dtm	EPA 200.8 Rev. 5.4

TRACE ID: T16L163-AL

Sample Point Description	Collected	Collected By	Received at Laboratory			
BK-111-CF	12/4/16 8:21	eb/nws/jjs	12/9/16 14:55			
Metals, Total	RESULT	* MCL	PREPARED	ANALYZED	BY	METHOD
Copper	2.1 mg/L	1.3	12/27/16 9:26	2/2/17 17:40	dtm	EPA 200.8 Rev. 5.4
Lead	0.023 mg/L	0.015	12/27/16 9:26	2/2/17 0:15	dtm	EPA 200.8 Rev. 5.4

* The MCL (Maximum Contamination Limit) is the maximum concentration allowed under the Federal Safe Drinking Water Act. Results that are reported in bold or red have equaled or exceeded the MCL.

Jon Mink
 Senior Project Manager



phone 231.773.5998
 toll-free 800.733.5998
 fax 231.773.6537

Trace Analytical Laboratories, Inc.
 2241 Black Creek Road
 Muskegon, MI 49444-2673
 info@trace-labs.com
 www.trace-labs.com

State of Michigan Laboratory ID: 8001

February 10, 2017

Mr. Stephen King
 Birmingham Public Schools
 2305 Cole Street
 Birmingham, MI 48009

PROJECT: Berkshire

TRACE ID: T16L163-AM

Sample Point Description	Collected	Collected By	Received at Laboratory			
BK-112-KF	12/4/16 8:38	eb/nws/js	12/9/16 14:55			
Metals, Total	RESULT	* MCL	PREPARED	ANALYZED	BY	METHOD
Copper	0.17 mg/L	1.3	12/27/16 9:26	2/2/17 0:18	dtm	EPA 200.8 Rev. 5.4
Lead	0.0014 mg/L	0.015	12/27/16 9:26	2/2/17 0:18	dtm	EPA 200.8 Rev. 5.4

TRACE ID: T16L163-AN

Sample Point Description	Collected	Collected By	Received at Laboratory			
BK-113-KF	12/4/16 8:39	eb/nws/js	12/9/16 14:55			
Metals, Total	RESULT	* MCL	PREPARED	ANALYZED	BY	METHOD
Copper	0.17 mg/L	1.3	12/27/16 9:26	2/2/17 0:20	dtm	EPA 200.8 Rev. 5.4
Lead	0.0012 mg/L	0.015	12/27/16 9:26	2/2/17 0:20	dtm	EPA 200.8 Rev. 5.4

TRACE ID: T16L163-AO

Sample Point Description	Collected	Collected By	Received at Laboratory			
BK-114-KF	12/4/16 8:40	eb/nws/js	12/9/16 14:55			
Metals, Total	RESULT	* MCL	PREPARED	ANALYZED	BY	METHOD
Copper	0.38 mg/L	1.3	12/27/16 9:26	2/2/17 0:23	dtm	EPA 200.8 Rev. 5.4
Lead	0.0012 mg/L	0.015	12/27/16 9:26	2/2/17 0:23	dtm	EPA 200.8 Rev. 5.4

* The MCL (Maximum Contamination Limit) is the maximum concentration allowed under the Federal Safe Drinking Water Act. Results that are reported in bold or red have equaled or exceeded the MCL.

Jon Mink
 Senior Project Manager

Birmingham Schools Fixture Inventory

Page 1 of

Building: Derkshire

Date Collected: 12/1/16
Sampler's Initials: EJS, NNS, JS

Trace ID: T12463
Logged by: JS
Checked by: GH

Trace No.	Time Taken	Sample Point	Location	Photo(s)	Aerator?	Connecting Plumbing	Notes
1	6:45	BK-01-BF	Custodial Office	2739	Y	Br, Cu	
2		BK-02-EW	Pool Filter Rm	2740	N	Cu, G	No eye wash
3	6:50	BK-03-BF	PE Office- Boy's	2741	Y	Br, Cu	
4		BK-04-BF	Boy's Locker Rm- Left	2742	Y	Br, Cu	No Out of order
5		BK-05-BF	Boy's Locker Rm- Right	2742	Y	Br, Cu	
6		BK-06-DS	Boy's Locker Rm	2743	N	Unknown	
7		BK-07-EW	Boy's Locker Rm	2744	N	Unknown	No eye wash
8	6:54	BK-08-CF	Rm 125	2745	N	Unknown	
9	6:56	BK-09-DF	Across from Rm 124-Left	2746	N	Unknown	
10	6:59	BK-10-DF	Across from Rm 124- Right	2746	N	Unknown	
11		BK-11-BF	Boy's by Rm 124-Left	2747	Y	Br, Cu	
12		BK-12-BF	Boy's by Rm 124- Right	2747	Y	Br, Cu	
13		BK-13-BF	Unisex by Rm 124	2748	Y	Br, Cu	
14		BK-14-BF	Girl's by Rm 124- Left	2749	Y	Br, Cu	
15		BK-15-BF	Girl's by Rm 124- Right	2749	Y	Br, Cu	
16	7:04	BK-16-CF	Rm 120 North Sink-1	2750	N	Br, Cu	
17		BK-17-CF	Rm 120 North Sink-2	2750	N	Br, Cu	} right from previous sink
18		BK-18-CF	Rm 120 North Sink-3	2750	N	Br, Cu	
19		BK-19-CF	Rm 120 South Sink-1	2751	N	Br, Cu	
20		BK-20-CF	Rm 120 South Sink-2	2751	N	Br, Cu	} left
21		BK-21-CF	Rm 120 South Sink-3	2751	N	Br, Cu	
22		BK-22-CF	Rm 120- Island	2752	N	Br, Cu	
23	7:05	BK-23-DF	Outside Rm 120	2753	N	Unknown	
24		BK-24-CF	Rm 119/120 Flask Sink	2754	N	Br, Cu	WASH WASH
25		BK-25-CF	Rm 119/120 Prep Rm	2755	N	Br, Cu	to right of door sink
26	7:13	BK-26-CF x	Rm 119 Station 4-1	2756	N	Br, Cu	See page 3 no
27		BK-27-CF x	Rm 119 Station 4-2	2756	N	Br, Cu	Station identification
28		BK-28-CF x	Rm 119 Station 5-1	2757	N	Br, Cu	
29		BK-29-CF x	Rm 119 Station 5-2	2757	N	Br, Cu	
30		BK-30-CF x	Rm 119 Station 6-1	2758	N	Br, Cu	
31		BK-31-CF x	Rm 119 Station 6-2	2758	N	Br, Cu	
32		BK-32-CF x	Rm 119 Station 1-1	2759	N	Br, Cu	
33		BK-33-CF x	Rm 119 Station 1-2	2759	N	Br, Cu	
34		BK-34-CF x	Rm 119 Station 2-1	2760	N	Br, Cu	
35		BK-35-CF x	Rm 119 Station 2-2	2760	N	Br, Cu	
36		BK-36-CF x	Rm 119 Station 3-1	2761	N	Br, Cu	
37		BK-37-CF x	Rm 119 Station 3-2	2761	N	Br, Cu	
38	7:15	BK-38-DF	Hall by 119	2762	B	Unknown	
39		BK-39-BF	Girl's by 119-Left	2763	Y	Br, Cu	
40		BK-40-BF	Girl's by 119- Left Middle	2763	Y	Br, Cu	
41		BK-41-BF	Girl's by 119-Right Middle	2763	Y	Br, Cu	

Released by: [Signature]

Received by: [Signature]

Date: 12/1/16 Time: 14:55

Birmingham Schools Fixture Inventory

Building: Berkshire

Date Collected: 12/1/16
 Sampler's Initials: EB, NWS, JS

Trace ID: TIGL163
 Logged by: JS
 Checked by: GH

Trace No.	Time Taken	Sample Point	Location	Photo(s)	Aerator?	Connecting Plumbing	Notes
42	7:15	BK-42-BF	Girl's by 119-Right	2763	Y	Br, Cu	
43	7:15	BK-43-DS	Custodial Rm by 119	2764	N	Unknown	
44	7:41	BK-44-CF	Rm 118-Left Wall- Left	2765/66	N	Br, Cu	
45		BK-45-CF	Rm 118-Left Wall-Right	2767/68	N	Br, Cu	
46		BK-46-CF	Rm 118-Back Wall- Left	2769/70	N	Br, Cu	
47		BK-47-CF	Rm 118-Back Wall-Left Middle	2771	N	Br, Cu	
48		BK-48-CF	Rm 118-Back Wall-Right Middle	2772/73	N	Br, Cu	
49		BK-49-CF	Rm 118-Back Wall- Right	2774/75	N	Br, Cu	
50		BK-50-CF	Rm 118-Right Wall- Left	2776/77	N	Br, Cu	
51		BK-51-CF	Rm 118-Right Wall-Right	2778/79	N	Br, Cu	
52		BK-52-CF	Rm 118- Teacher's Sink	2780	N	Br, Cu	
53	7:22	BK-53-CF	Rm 118- Prep Rm	2781	N	Br, Cu	
54	7:26	BK-54-CF	Rm 116-Right Wall-Right	2782/83	N	Br, Cu	
55		BK-55-CF	Rm 116-Right Wall-Left	2784/85	N	Br, Cu	
56		BK-56-CF	Rm 116-Back Wall-Right	2786/87	N	Br, Cu	
57		BK-57-CF	Rm 116-Back Wall-Right Middle	2788/89	N	Br, Cu	
58		BK-58-CF	Rm 116-Back Wall-Left Middle	2790/91	N	Br, Cu	
59		BK-59-CF	Rm 116- Back Wall- Left	2792/93	N	Br, Cu	
60		BK-60-CF	Rm 116-Left Wall- Right	2794/95	N	Br, Cu	
61		BK-61-CF	Rm 116-Left Wall- Left	2796/97	N	Br, Cu	
62		BK-62-CF	Rm 116- Teacher's Sink	2798/99	N	Br, Cu	
63	7:27	BK-63-CF	Rm 116- Prep Rm	2800/01	N	Br, Cu	
64	7:30	BK-64-CF	Rm 114-Right Wall-Right	2802/03	N	Br, Cu	
65		BK-65-CF	Rm 114-Right Wall-Left	2804/05	N	Br, Cu	
66		BK-66-CF	Rm 114-Back Wall- Right	2806/07	N	Br, Cu	
67		BK-67-CF	Rm 114-Back Wall-Right Middle	2808/09	N	Br, Cu	
68		BK-68-CF	Rm 114-Back Wall-Left Middle	2810/11	N	Br, Cu	
69		BK-69-CF	Rm 114-Back Wall-Left	2812/13	N	Br, Cu	
70		BK-70-CF	Rm 114-Left Wall-Right	2814/15	N	Br, Cu	
71		BK-71-CF	Rm 114-Left Wall- Left	2816/17	N	Br, Cu	
72		BK-72-CF	Rm 114-Teacher's Sink	2818	N	Br, Cu	Out of Service
73		BK-73-DF	Hall by 113	2819	N	Unknown	out of service
74	7:33	BK-74-BF	Boy's by 113-Left	2820	Y	Br, Cu	
75		BK-75-BF	Boy's by 113-Left Middle	2820	Y	Br, Cu	
76		BK-76-BF	Boy's by 113-Right Middle	2820	Y	Br, Cu	
77		BK-77-BF	Boy's by 113-Right	2820	Y	Br, Cu	
78		BK-78-DS	Custodial Rm by 113	2821	N	Unknown	
79	7:34	BK-79-CF	Rm 113	2822/23	Y	Br, Cu	
80	7:35	BK-80-CF	Rm 110	2824/25	Y	Br, Cu	
81	7:39	BK-81-DF	Outside 205	2826	N	Unknown	
82	7:40	BK-82-DS	Custodial by 205	2827	N	Unknown	

Released by: [Signature] Received by: [Signature] Date: 12/1/16 Time: 14:55

Birmingham Schools Fixture Inventory

Page 3 of _____

Building: Berkshire

Date Collected: 12/1/16
Sampler's Initials: EJB, MWS, JS

Trace ID: TTGL163
Logged by: JS
Checked by: G/J

Trace No.	Time Taken	Sample Point	Location	Photo(s)	Aerator?	Connecting Plumbing	Notes
83	9:12	BK-83-BF	Boy's by 205-Left	2828	Y	Br, Cu	
84		BK-84-BF	Boy's by 205-Left Middle	2828	Y	Br, Cu	
85		BK-85-BF	Boy's by 205-Right Middle	2828	Y	Br, Cu	
86		BK-86-BF	Boy's by 205-Right	2828	Y	Br, Cu	
87		BK-87-BF	Girl's by 213-Left	2829	Y	Br, Cu	
88		BK-88-BF	Girl's by 213-Left Middle	2829	Y	Br, Cu	
89		BK-89-BF	Girl's by 213-Right Middle	2829	Y	Br, Cu	

Rm 119

Rm 103

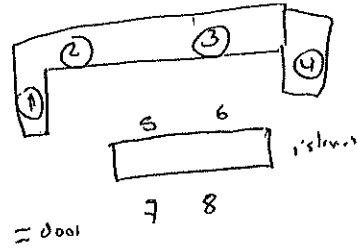
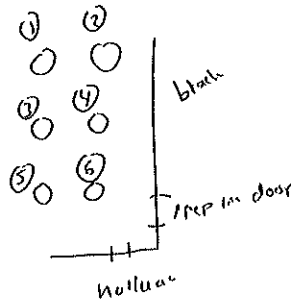

Released by: [Signature] Received by: [Signature]

Date: 12/1/16 Time: 14:55



the science of compliance

phone 231.773.5998
 toll-free 800.733.5998
 fax 231.773.6537

Trace Analytical Laboratories, Inc.
 2241 Black Creek Road
 Muskegon, MI 49444-2673
 info@trace-labs.com
 www.trace-labs.com

Birmingham Schools Fixture Inventory

Page 4 of _____

Building: Berkshire

Date Collected: 12/1/16
 Sampler's Initials: EFB, NWS, JS

Trace ID: T16L163
 Logged by: JS
 Checked by: EFB

Trace No.	Time Taken	Sample Point	Location	Photo(s)	Aerator?	Connecting Plumbing	Notes
83	7:12	BK-83-BF	Boy's by 205-Left	2828	Y	Br, Cu	
84		BK-84-BF	Boy's by 205-Left Middle	2828	Y	Br, Cu	
85		BK-85-BF	Boy's by 205-Right Middle	2828	Y	Br, Cu	
86		BK-86-BF	Boy's by 205-Right	2828	Y	Br, Cu	
87		BK-87-BF	Girl's by 213-Left	2829	Y	Br, Cu	
88		BK-88-BF	Girl's by 213-Left Middle	2829	Y	Br, Cu	
89		BK-89-BF	Girl's by 213-Right Middle	2829	Y	Br, Cu	
90	9:05	BK-90-BF	Girl's by 213-Right	2829	Y	Br, Cu	
91	9:06	BK-91-DF	Hall by 213	2830	N	Unknown	
92	9:16	BK-92-DS	Custodial Rm by 213	2831	N	Unknown	
93	no sample	BK-93-DF	Hall by 215	2832	N	Unknown	
94	8:09	BK-94-KF	Teacher's Lounge	2833/34	Y	Br, Cu	
95	9:01	BK-95-KF	Media Center Lounge	2835/36	Y	Br, Cu	
96	8:10	BK-96-BF	Women's by Teacher Lounge-L	2837	Y	Br, Cu	
97	9:11	BK-97-BF	Women's by Teacher Lounge-R	2837	Y	Br, Cu	
98	8:12	BK-98-BF	Men's by 101-Left	2838	Y	Br, Cu	
99	8:13	BK-99-BF	Men's by 101-Right	2838	Y	Br, Cu	
AA	8:14	BK-100-DF	Hall by 101	2839	N	Unknown	
AB	8:15	BK-101-Bottle	Hall by 101	2839	N	Unknown	
AC	8:08	BK-102-BF	Unisex by Office	2840	Y	Br, Cu	
AD	8:14	BK-103-CF	Rm 101-Front	2841	Y	Br, Cu	
AE	8:14	BK-104-CF	Rm 101- Back Right	2842/43	Y	Br, Cu	
AF	8:18	BK-105-CF	Rm 101-Back Middle	2844/45	Y	Br, Cu	
AG	8:17	BK-106-CF	Rm 101-Back Left	2846	Y	Br, Cu	
AH	8:20	BK-107-CF	Rm 102-Right Wall-Right	2847	Y	Br, Cu	
AI	8:23	BK-108-CF	Rm 102-Right Wall- Left	2848	Y	Br, Cu	
AJ	8:20	BK-109-CF	Rm 102-Front	2849	Y	Br, Cu	
AK	8:22	BK-110-CF	Rm 102-Left Wall-Right	2850	Y	Br, Cu	
AL	8:21	BK-111-CF	Rm 102-Left Wall-Left	2851	Y	Br, Cu	
AM	8:26	BK-112-KF	Kitchen Triple Sink-Left	2853/54	N	Br, Cu	
AN	8:27	BK-113-KF	Kitchen Triple Sink-Middle	2853/54	N	Br, Cu	
AO	8:40	BK-114-KF	Kitchen Triple Sink-Right	2853/54	N	Br, Cu	
AP	8:41	BK-115-KF	Kitchen Deep Sink	2855/56	Y	Br, Cu	
AQ	8:48	BK-116-KF	Kitchen Double Sink-Left	2857/58	N	Br, Cu	
AR	8:49	BK-117-KF	Kitchen Double Sink-Right	2857/58	Y	Br, Cu	
AS	8:44	BK-118-HS	Kitchen	2859	Y	Br, Cu	
AT	8:45	BK-119-DS	Kitchen-Custodial Rm	2860	N	Unknown	
AU	8:46	BK-120-BF	Kitchen-Women's	2861/62	Y	Br, Cu	
AV	8:42	BK-121-KF	Kitchen- Island	2863/64	Y	Br, Cu	
AW	no sample	BK-122-HS	Snack Rm	2865	Y	Br, Cu	
AX	8:37	BK-123-DF	Cafeteria	2866	N	Unknown	

Released by:

Received by:

Date: 12/1/16 Time: 14:55



phone 231.773.5998
 toll-free 800.733.5998
 fax 231.773.6537

Trace Analytical Laboratories, Inc.
 2241 Black Creek Road
 Muskegon, MI 49444-2673
 info@trace-labs.com
 www.trace-labs.com

Birmingham Schools Fixture Inventory

Page 5 of

Building: Berkshire

Date Collected: 12/16
 Sampler's Initials: JB, NWS, JS

Trace ID: TL6163
 Logged by: JS
 Checked by: GH

Trace No.	Time Taken	Sample Point	Location	Photo(s)	Aerator?	Connecting Plumbing	Notes
124	8 ⁵⁵	BK-124-CF	Rm 107	2867/68	Y	Br, Cu	
125	8 ⁵⁶	BK-125-CF	Rm 108-1	2869/70	Y	Br, Cu	
126	8 ⁵⁷	BK-126-CF	Rm 108-2	2871/72	Y	Br, Cu	
127	9 ⁰¹	BK-127-CF	Rm 108-6	2873/74	Y	Br, Cu	
128	9 ⁰⁰	BK-128-CF	Rm 108-5	2875/76	Y	Br, Cu	
129	8 ⁵⁷	BK-129-CF	Rm 108-3	2877/78	Y	Br, Cu	
130	8 ⁵⁷	BK-130-CF	Rm 108-4	2879/80	Y	Br, Cu	
131	9 ⁰³	BK-131-CF	Rm 108-Island- Right	2881/82	Y	Br, Cu	
132	9 ⁰²	BK-132-CF	Rm 108-Island-Left	2883/84	Y	Br, Cu	
133	6 ⁵⁸	BK-133-DS	Main Office-Custodial	2885	N	Unknown	
134	8 ⁰⁶	BK-134-BF	Main Office Restroom	2886	Y	Br, Cu	
135	8 ⁰⁵	BK-135-KF	Main Office Breakroom	2887/88	Y	Br,Cu, P	
136	8 ⁰⁷	BK-136-BF	Main Office Clinic	2889	Y	Br, Cu	
137	8 ⁰³	BK-137-DF	Gym-East-Left	2890	N	Unknown	
138	no sample	BK-138-DF	Gym-East-Right	2890	N	Unknown	No water pressure
139	8 ⁰¹	BK-139-DF	Gym-West-Left	2891	N	Unknown	
140	8 ⁰²	BK-140-DF	Gym-West-Right	2891	N	Unknown	
141	7 ⁰³	BK-141-DF	Pool-West	2892	N	Unknown	
142	7 ⁵⁵	BK-142-DF	Pool-East	2893	N	Unknown	
143	7 ⁵⁰	BK-143-DF	Rm 128	2894	N	Unknown	
144	7 ⁵⁷	BK-144-HS	Rm 128	2895	N	Unknown	
145	7 ⁵⁸	BK-145-DF	Rm 129	2896	N	Unknown	
146	7 ⁵⁹	BK-146-HS	Rm 129	2897	N	Unknown	
147	8 ⁰⁰	BK-147-DF	Rm 130	2898	Y	Br, Cu	
148	7 ⁰⁰	BK-148-BF	Girl's Locker-Left	2899	Y	Br, Cu	
149	7 ⁰¹	BK-149-BF	Girl's Locker-Right	2899	Y	Br, Cu	
150	7 ⁰²	BK-150-DS	Girl's Locker- Custodial	2900	N	Unknown	
151	6 ⁵¹	BK-151-BF	Girl's Locker PE Office	2901	Y	Br, Cu	
DE	8-43	BK-152-KF	Steam Kettle				

Abbreviations:

- B= Classroom Bubbler
- BF= Bathroom Faucet
- Bottle= Bottle Filler
- CF= Classroom Faucet
- DF= Drinking Fountain
- DS= Deep Sink
- EW= Eye Wash
- HS= Hand Sink
- KF= Kitchen Faucet

Connecting Plumbing:

- Br= Brass
- Cu= Copper
- G= Galvanized
- P= Plastic
- SS= Stainless Steel

DF no sample BK-153-HS Back of Kitchen out of service

Released by: [Signature]

Received by: [Signature]

Date: 12/16 Time: 11:55

Birmingham Schools Chain-of-Custody Record

Building: Berkshire

Date Collected: 12/1/16
Sampler's Initials: E.B., N.D.S., J.S.

Trace ID: T161163
Logged by: J.S.
Checked by: G.D.

Trace No.	Time Taken	Sample Point	Location	Photo(s)	Aerator?	Connecting Plumbing	Notes
152		9:20	A-1 Custodial Booth				
153			A-2				
154			A-3				
155			A-4				
156			A-5				
157			A-6				
158			A-7				
159			A-8				
160			A-9				
161			A-10				
162		9:25	B-1 <i>boys by 12th A.</i>				
163			B-2				
164			B-3				
165			B-4				
166			B-5				
167			B-6				
168			B-7				
169			B-8				
170			B-9				
171			B-10				
172		9:30	C-1 (M-102)				
173			C-2				
174			C-3				
175			C-4				
176			C-5				
177			C-6				
178			C-7				
179			C-8				
180			C-9				
181		9:35	C-10				

Released by: [Signature] Received by: [Signature] Date: 12/1/16 Time: 11:55

SAMPLE LOG IN CHECKLIST

Trace ID #: 1761-163 Date: 12/1/16 Package Description: Cooler Temperature: 20.0
 Client Name: Birmingham - Berkshire Time: 14:55 Logged in by: JS

Cooler Receipt

Cooler/samples delivered by: Trace courier Hand delivered Commercial courier UPS FED EX US Mail

Name of delivery person: Evan Brunster

Tracking Number: Not Applicable
 Tracking #: _____

COC Seals present and intact on cooler? No Yes Not Applicable

Custody seals signed by Client? No Yes Client custody seal # (if applicable): _____

Coolant and Temperature

Type of Coolant Used
 Slurry w/ crushed, cubed, or chip ice?
 Multiple bags of ice around samples?
 Ice Packs/ Blue Ice:
 No Coolant Present:

Ice still present upon receipt (circle one):
 Yes No N/A

Cooler Temperature
 Correction Factors: • Digital Stick Thermometer CF = -0.4°C
 • IR Thermometer Glass CF = -0.1°
 • IR Thermometer Plastic CF = +1.1°C

Temperature Blank: None °C (Digital Stick Thermometer)
 Range of 3 samples: 20.0 °C (IR Plastic or IR Glass - Circle one)
 Melt Water: None °C (Use Digital Stick Thermometer)

General

	Yes	No	NA	Comments
All bottles arrived unbroken with labels in good condition?	<input checked="" type="checkbox"/>	<input type="checkbox"/>	<input type="checkbox"/>	
Each sample point is in a sealed plastic bag?	<input type="checkbox"/>	<input checked="" type="checkbox"/>	<input type="checkbox"/>	
Labels filled out completely?	<input checked="" type="checkbox"/>	<input type="checkbox"/>	<input type="checkbox"/>	
All bottle labels agree with Chain of Custody (COC)?	<input checked="" type="checkbox"/>	<input type="checkbox"/>	<input type="checkbox"/>	
Sufficient sample to run tests requested?	<input checked="" type="checkbox"/>	<input type="checkbox"/>	<input type="checkbox"/>	
pH checked and samples at correct pH?	<input checked="" type="checkbox"/>	<input type="checkbox"/>	<input type="checkbox"/>	See Below*
Correct preservative added to samples?	<input checked="" type="checkbox"/>	<input type="checkbox"/>	<input type="checkbox"/>	
Air bubbles absent from VOAs?	<input type="checkbox"/>	<input type="checkbox"/>	<input checked="" type="checkbox"/>	
COC filled out properly and signed by client?	<input checked="" type="checkbox"/>	<input type="checkbox"/>	<input type="checkbox"/>	
COC signed in by TRACE sample custodian?	<input checked="" type="checkbox"/>	<input type="checkbox"/>	<input type="checkbox"/>	
Was project manager called and samples discussed?	<input type="checkbox"/>	<input checked="" type="checkbox"/>	<input type="checkbox"/>	

Notes: _____

*EMD pH Test Strips Used:
 pH 0-2.5 Lot: HC563733 pH 11.0-13.0 Lot: HC547320
 Other: _____

Lot: HC563733 verified 01/21/16 AY
 Lot: HC547320 verified 01/30/16 AY

