

6TH GRADE COURSE SELECTION SHEET

Name _____ School _____ Teacher _____

****Social Studies, Science, Rotation (10 weeks each of Art, Engineering Tech, PE and Skills for Living) and A2 have been pre-selected. Select your other courses by completing steps 1-4.**

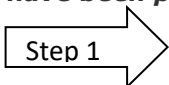

Step 1 Choose This 6th Grade Language Arts Course

Choose Language Arts (LA6).

<input checked="" type="checkbox"/> Course Name	Number	Prerequisite Note
<input type="checkbox"/> Lang Arts 6	LA6	

Return to your 5th Grade
Teacher By:

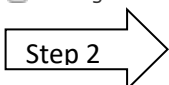

Step 2 Choose One 6th Grade Math Course

Please follow the recommendation of your current math teacher when selecting the math class for next year.

<input checked="" type="checkbox"/> Course Name	Number	Prerequisite Note
<input type="checkbox"/> Adv Math 6	AMA6	Advanced Math level. Teacher recommendation is required.
<input type="checkbox"/> Math 6	MATH6	Teacher recommendation is required.

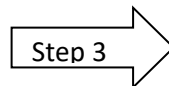

Step 3 Choose 6th Grade Elective Courses

Students must select **TWO every other day** classes. If students select AARI, they must additionally select it below.

<input checked="" type="checkbox"/> Course Name	Number	Prerequisite Note
<input type="checkbox"/> Band 6	BAND6	This is an every other day class.
<input type="checkbox"/> Chinese 6	CHIN6	This is an every other day class.
<input type="checkbox"/> Choir 6	CHOIR6	This is an every other day class.
<input type="checkbox"/> French 6	FREN6	This is an every other day class.
<input type="checkbox"/> Literacy 6	LITRS6	Teacher recommendation is required. This is an every other day class.
<input type="checkbox"/> Math Lab 6	MTHLAB6	Teacher recommendation is required. This is an every other day class.
<input type="checkbox"/> Music Stat 6	MUSIC6	This is an every other day class. <input type="checkbox"/>
<input type="checkbox"/> Orchestra 6	ORCH6	This is an every other day class.
<input type="checkbox"/> PE6 Eod	PE6EOD	This is in addition to your 10 week required PE class in your rotation. This is an every other day class.
<input type="checkbox"/> Reading Enr6	RE6	This is an every other day class.
<input type="checkbox"/> Spanish 6	SPAN6	This is an every other day class.
<input type="checkbox"/> Strategies 6	Strat6	Teacher recommendation required. This is an every other day class.
<input type="checkbox"/> AARI	AARI	Teacher recommendation required. This is an everyday class for 1 semester (20 weeks).

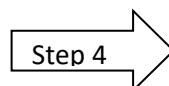

Step 4 Choose 6th Grade Alternate Elective Courses

All elective combinations are not possible, so please carefully select **2 NEW** alternates. **DO NOT** include electives already selected.

<input checked="" type="checkbox"/> Course Name	Number	Prerequisite Note
<input type="checkbox"/> Band 6	BAND6	This is an every other day class.
<input type="checkbox"/> Chinese 6	CHIN6	This is an every other day class.
<input type="checkbox"/> Choir 6	CHOIR6	This is an every other day class.
<input type="checkbox"/> French 6	FREN6	This is an every other day class.
<input type="checkbox"/> Music Stat 6	MUSIC6	This is an every other day class.
<input type="checkbox"/> Orchestra 6	ORCH6	This is an every other day class.
<input type="checkbox"/> PE6 Eod	PE6EOD	This is in addition to your 10 week required PE class in your rotation. This is an every other day class.
<input type="checkbox"/> Reading Enr6	RE6	This is an every other day class.
<input type="checkbox"/> Spanish 6	SPAN6	This is an every other day class.

Parent/guardian signature: _____ Parent/guardian phone #: _____

Date: _____